

**COMPRESSOR**

Displacement (cm3)	9.95
Diameter (mm)	25.40
Stroke (mm)	19.62
Net weight w/o driver (kg)	9.1
Oil type	ISO 15 ESTER
Oil charge (cm3)	400

**APPLICATION**

Application	High/Medium Back Pressure
Refrigerant	R134a
Evaporating (°C)	From -25 to +10
Expansion system	Capillary / Expansion valve
Compressor cooling	Fan cooled
Maximum ambient temp (°C)	43

**MOTOR**

Nominal Voltage/Freq (V/Hz)	220-240/50
Voltage range (V)	187-264
Motor protection	Overload protector

**PROTECTIONS OF ELECTRONIC DRIVER FAC1**

Low voltage protection
Fan over-current
Starting failure
Fan failure
Compressor overload
Electronic driver over-heat

**COMPRESSOR SPEED SELECTION**

By programming or switching the external connectors

**PERFORMANCE OF COMPRESSOR**

Performances of GLT99FSN model in function of rotor speed and evaporating temperature:

Speed	GLT99FSN							
	Refrigerating capacity and COP							
	Evaporating temperature							
	-25°C		-10°C		0°C		+7,2°C	
<i>rpm</i>	<i>kcal/h</i>	<i>W/W</i>	<i>kcal/h</i>	<i>W/W</i>	<i>kcal/h</i>	<i>W/W</i>	<i>kcal/h</i>	<i>W/W</i>
1500	87	1,28	209	1,80	330	2,29	454	2,75
1800	106	1,31	255	1,91	399	2,42	548	2,90
2400	143	1,36	331	1,95	516	2,44	704	2,83
3000	173	1,37	409	1,93	641	2,42	877	2,82
3600	197	1,34	468	1,84	755	2,32	1053	2,71

Testing cycle conditions	
Condensing temperature	55°C
Subcooling	9K
Suction temperature	35°C
Ambient temperature	35°C

Voltage / Frequency test	230V / 50Hz
--------------------------	-------------

**COMPRESSOR DIMENSIONS**

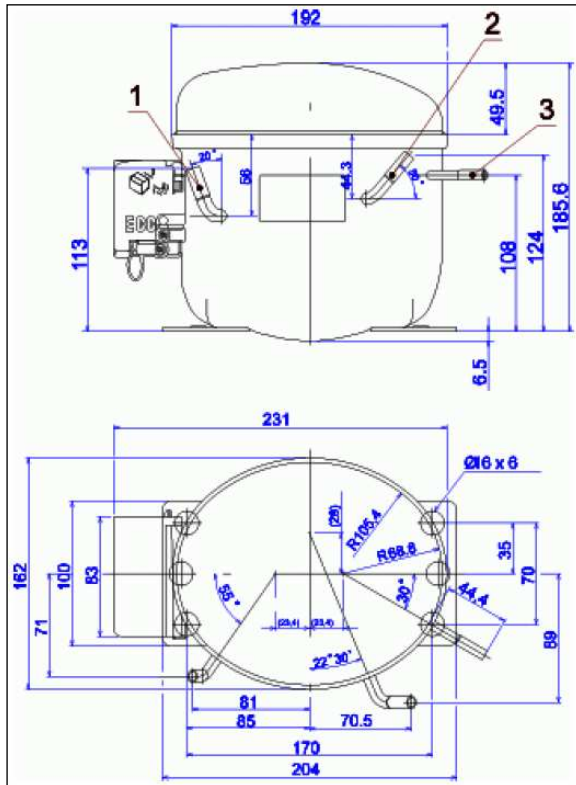

	DESIGNATION	INTERNAL DIAM. (MM)
1	Suction/Service	6.5
2	Service/Suction	6.5
3	Discharge	4.9

**EXTERNAL AND ELECTRICAL PARTS ASSEMBLY**

